

How to use the Business Reply Envelope (BRE)

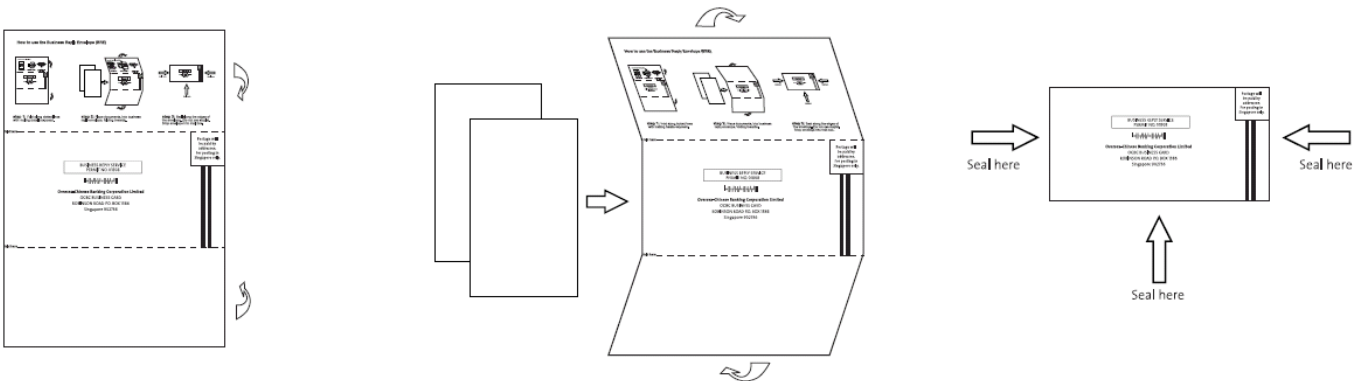

Step 1
Fold along the dotted lines. Fold the top and bottom sections inwards with the mailing address in front.

Step 2
Enclose your documents within the sleeve created in Step 1.

Step 3
Seal the edges with clear tape to secure your documents inside.

BUSINESS REPLY SERVICE
PERMIT NO. 01808



Oversea-Chinese Banking Corporation Limited
OCBC BUSINESS CREDIT CARD
ROBINSON ROAD P.O. BOX 1386
Singapore 902736

Postage will be paid by addressee.
For posting in Singapore only.